

Squared Toe Post-Op Shoe Impax™ Grid

PATIENT APPLICATION



BEFORE USING THIS DEVICE, PLEASE READ THE FOLLOWING INSTRUCTIONS COMPLETELY AND CAREFULLY. CORRECT APPLICATION IS VITAL TO THE PROPER FUNCTIONING OF THE DEVICE.

INTENDED USE

Replacement Insole for use with the Squared Toe Post-Op Shoe

CONTRAINDICATIONS

N/A

APPLICATION INFORMATION

- 1) Open forefoot flaps of the Squared Toe Post-Op Shoe.
- 2) Firmly grasp the edge of the gray Squared Toe Post-Op Shoe insole and remove from shoe.
- 3) With the Impax Grid Insole in hand, locate and remove the pre-cut foam cubes from the bottom of the Insole as desired to relieve pressure.
- 4) Place the Impax Grid Insole (pink side down) into the shoe. The blue side of Impax Grid Insole should be against bottom of foot.

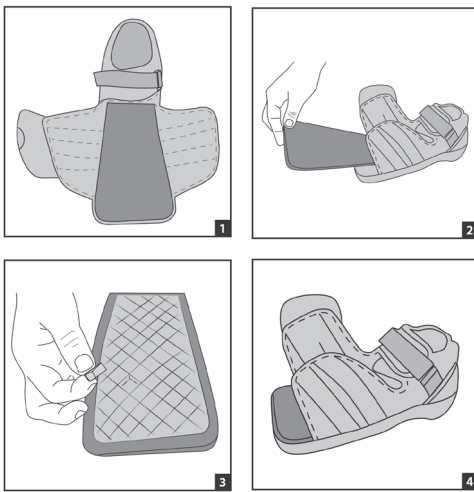

WARRANTY:

DJO, LLC will repair or replace all or part of the unit and its accessories for material or workmanship defects for a period of six months from the date of sale.

NOT MADE WITH NATURAL RUBBER LATEX.

MATERIAL COMPOSITION:

Insole: Ethylene Vinyl Acetate

NOTICE: WHILE EVERY EFFORT HAS BEEN MADE IN STATE-OF-THE-ART TECHNIQUES TO OBTAIN THE MAXIMUM COMPATIBILITY OF FUNCTION, STRENGTH, DURABILITY AND COMFORT, THERE IS NO GUARANTEE THAT INJURY WILL BE PREVENTED THROUGH THE USE OF THIS PRODUCT.



DJO, LLC
T 800.336.6569 D 760.727.1280 F 800.936.6569
2900 Lake Vista Drive | Lewisville, TX 75067 | U.S.A.
DJOglobal.com