

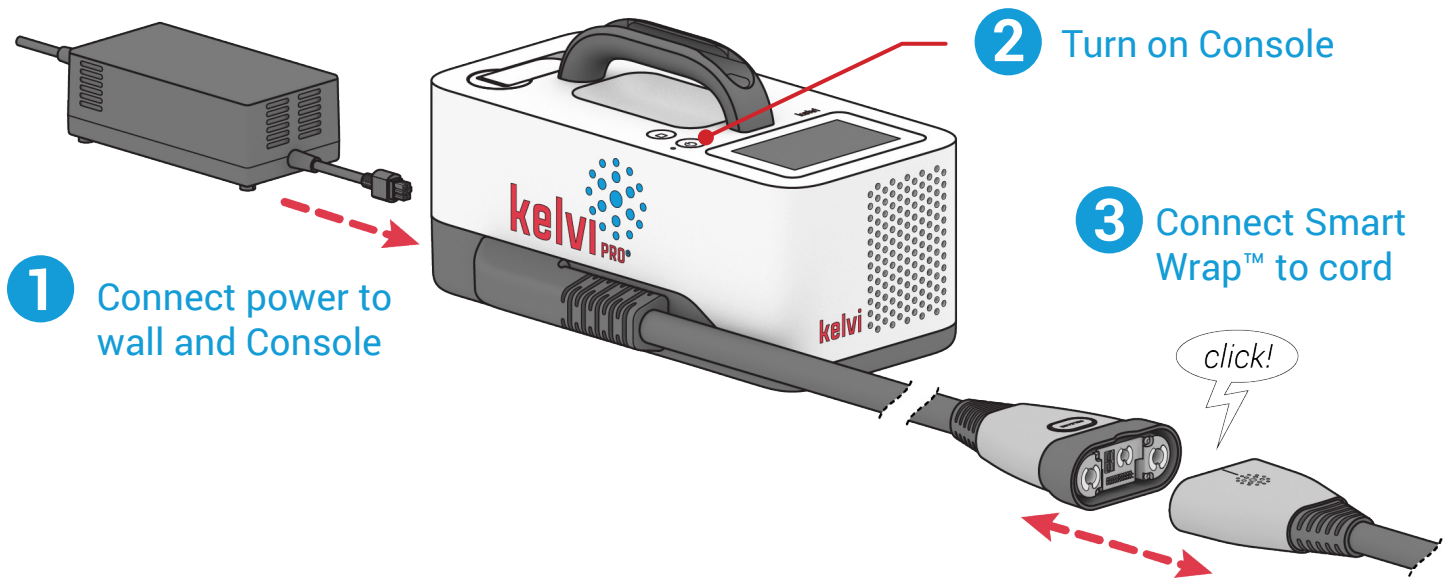

Back Pro Smart Wrap™ Quick Start Guide

Setting Up the Kelvi Pro^e Console



Applying the Smart Wrap™

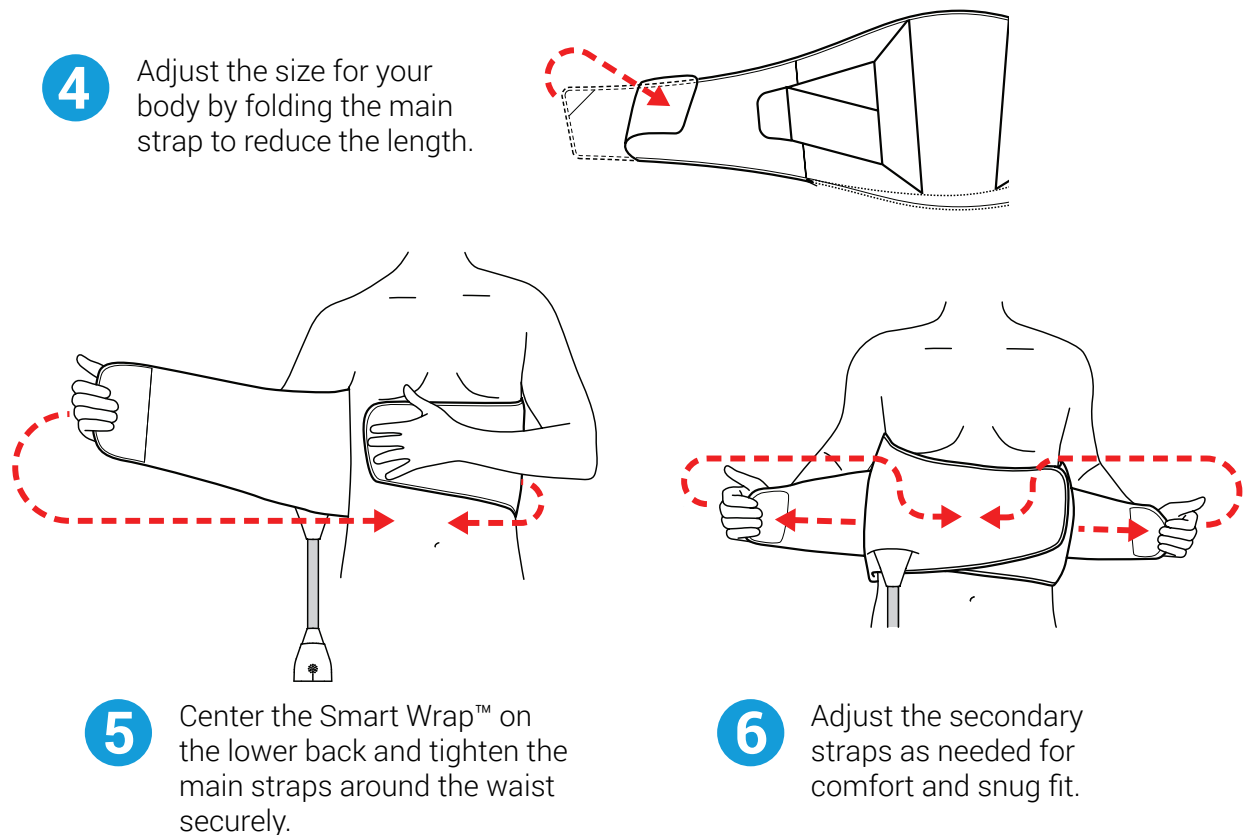

Setting Up Treatment*

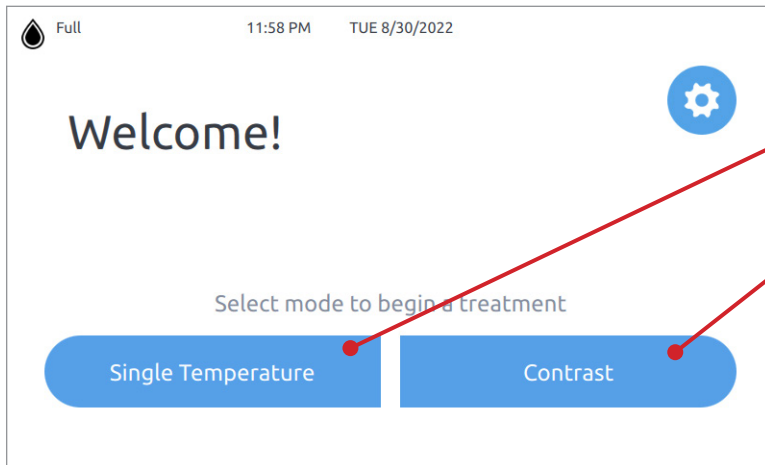

7 Select treatment type

On the touchscreen, select **Single Temperature** for constant treatment

Select **Contrast** for alternating cool and hot treatment

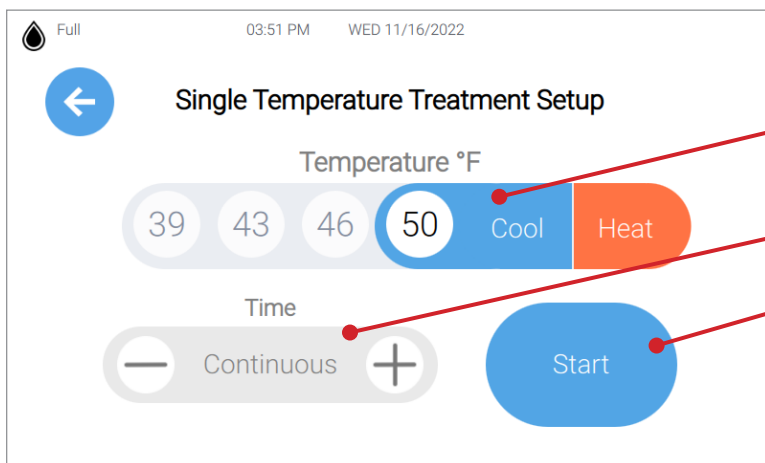

8 Set temperature and time

Select **Cool** or **Heat**, then select temperature.

Set a time limit or choose **Continuous**.

Press **Start** to begin treatment.

Smart Wrap™ may be adjusted as needed for comfort during treatment.

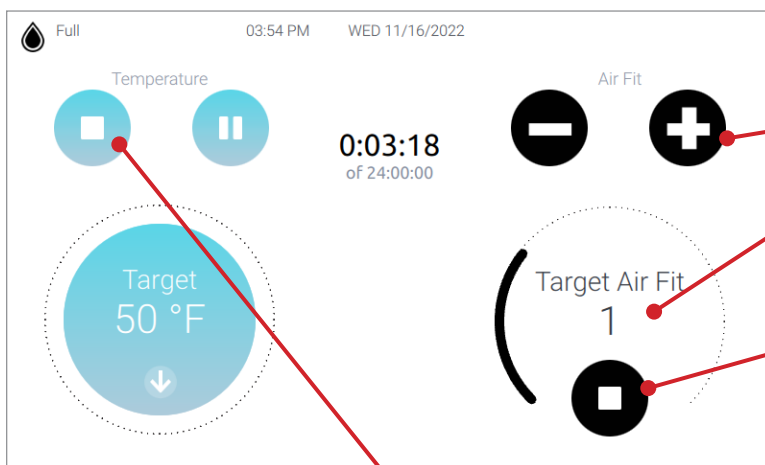

9 Adjust air pressure for fit

Select **+** or **-** to change air pressure.

Start low and increase by one level at a time. Do not exceed comfortable pressure.

Press **Stop** to release air pressure.

Press **Stop** to end treatment.

* Follow clinician prescription for treatment



Scan here for complete instructions for use



IMPORTANT: Read complete instructions including indications, contraindications, cautions, and warnings before using this product. For assistance in using the Kelvi Pro™ System, contact your licensed or certified healthcare professional.

